

One Electric

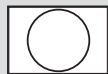

Available Screen Materials



Arctiq

The screen fabric has a matt white surface.



GreyLight (gain 0.93)

The screen fabric has a high contrast matt grey surface.



FlexRear

Grey rear projection diffusing surface. Provides high resolution and excellent contrast.



Acoustic

White sound transparent material which provides 180° viewing angle.

Available Formats

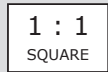

1 : 1
SQUARE

The screen format is 1:1. No black borders.



4 : 3
VIDEO

The screen has 5 cm wide black borders. The format of the viewing area is 4:3.



16 : 10
DATA

The screen has 5 cm wide black borders. The format of the viewing area is 16:10.



16 : 9
WIDE

The screen has 5 cm wide black borders. The format of the viewing area is 16:9.



2.35 : 1
CINEMASCOPE

The screen has 5 cm wide black borders. The format of the viewing area is 2.35:1.

Control Options

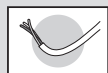

Installation

5m cable. Needs to be installed by electrician.



Switch

The screen is operated by a 3-positions in-line switch.



Remote Control

The screen is operated by a 3-positions RF remote control.



AutoLink

The screen goes automatically down/up when turning the projector on/off.

One Electric is a high quality screen with exclusive design – the architect's choice. It is also very popular as a complement to flat TV's since the "floating" case, made of anodized aluminium, brings the screen in front of the TV. The installation is very flexible with mounting brackets that can be adjusted sideways to preferred positions and the screen can be mounted on the wall as well as in the ceiling. It can be operated by an in-line switch, an IR remote control or automatically by an AutoLink connected to the projector. For system installations it's also available with cable only. All control options are easily connected to the screen via the universal connector on the screens backside.

Screen Dimensions

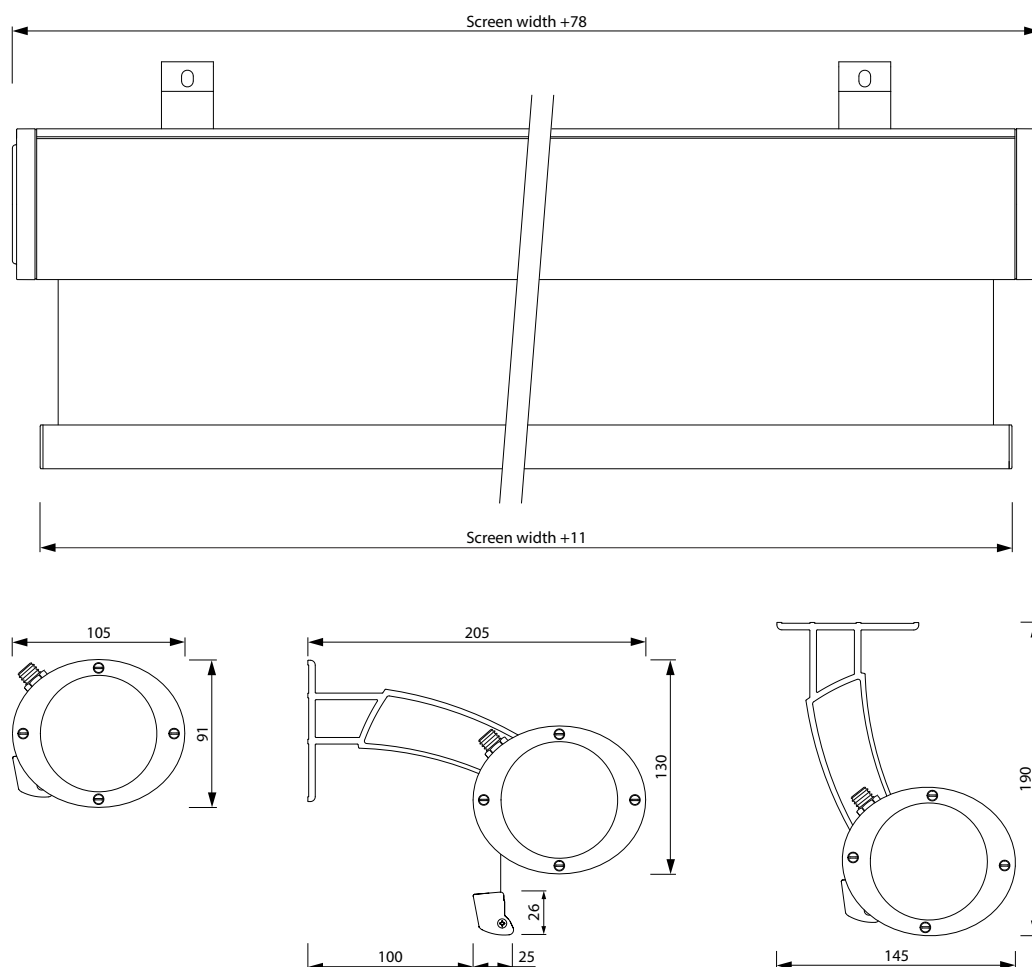

Example – One Electric Dimensions

Model: OE240

Screen width: 2400mm

Total width: 2400 mm + 78 mm = 2478 mm

Bar width: 2400 mm + 11 mm = 2411 mm

All dimensions in this document are in mm

Document PDSOE ver 1.1, page 1 of 3



Bjurab Sweden AB
Kristinebergsvägen 22
SE-302 41 Halmstad
Sweden

Tel: +46 – 35 – 144290
Fax: +46 – 35 – 144291
Email: info@bjurab.se
Web: www.bjurab.se

Bracket Dimensions

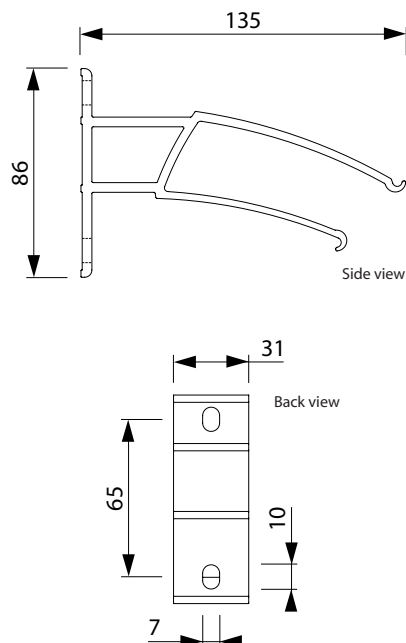

Packaging Dimensions

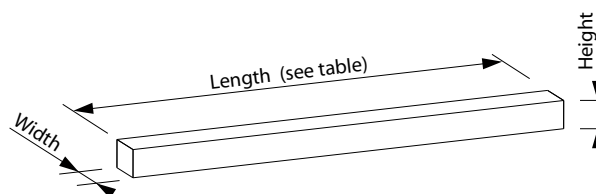

Screen width	Box length	Box width	Box height
1600	2090	185	115
1800	2290	185	115
2000	2490	185	115
2200	2690	185	115
2400	2890	185	115
2700	3190	185	115
3000	3490	185	115



Switch

Enclosed with the screen, when ordered.

Weight – 0.32kg



Installation

Enclosed with the screen, when ordered.

Weight – 0.40kg

Remote Control

Delivered separately



Art. no euro plug: 210695

UK plug: 210695-UK

Communication – Infrared
 Batteries handcontrol – 2pcs 1,5 volt AAA, included
 Dim. & weights – Handcontrol: 162 x 50 x 28 (0.085kg)
 Reciever: 120 x 72 x 35 (0.42kg)
 Package: 710 x 105 x 56
 Weight all together – 0.64kg



AutoLink

Art. no euro plug: 210700

Delivered separately

UK plug: 210700-UK

Communication – Infrared
 Dim. & weights – Reciever: 120 x 72 x 35 (0.42kg)
 Transmitter: 103 x 57 x 36 (0.26kg)
 Package: 710 x 105 x 56

Weight all together – 0.87kg

Switch

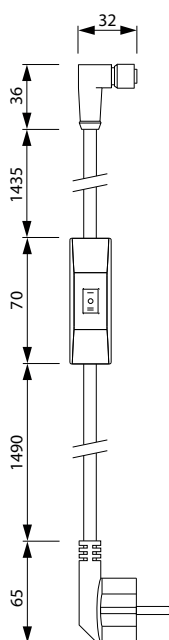

Installation

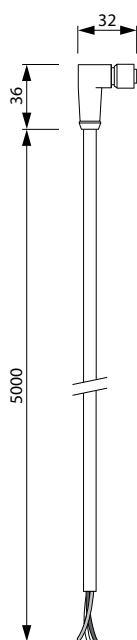

Reciever

part of Remote Control as well as AutoLink

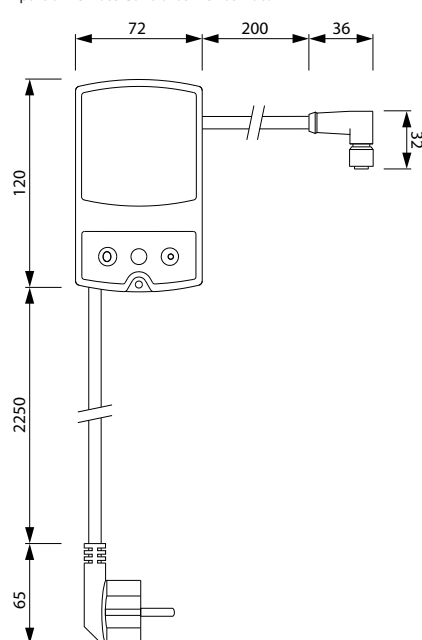

Transmitter

part of AutoLink

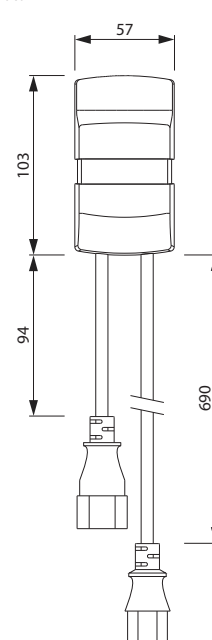

All dimensions in this document are in mm.

Document PDSOE ver 1.1, page 2 of 3



Bjurab Sweden AB
 Kristinebergsvägen 22
 SE-302 41 Halmstad
 Sweden

Tel: +46 – 35 – 144290
 Fax: +46 – 35 – 144291

Email: info@bjurab.se
 Web: www.bjurab.se

Electrical specifications

Plug options



Motorized screens, except Installation version, are delivered with either Euro plug or UK plug (both grounded).

Motor Specifications

Voltage: 220 V Frequency: 50 Hz
Power: 85 W Momentum: 6Nm
Speed: 28 rpm Protection: IP44

The motor is grounded

Cable Specifications

Thickness: Ø 7 mm
Cable area: 4x0,34mm², motor to control
3x0,34mm², control to plug
Wires: Black - Up, Brown - Down
Blue - Neutral
Green/Yellow - Ground

Article Numbers for One Electric

Square Format, 1 : 1

ART. NO	SCREEN SIZE WIDTH x HEIGHT	WT. KG
OE160	1600 x 1600	
OE180	1800 x 1800	
OE200	2000 x 2000	
OE220	2200 x 2200	
OE240	2400 x 2400	
OE270	2700 x 2700	
OE300	3000 x 3000	

Video Format, 4 : 3

ART. NO	SCREEN SIZE WIDTH x HEIGHT	VIEW AREA WIDTH x HEIGHT	WT. KG
OE1617-V	1600 x 1850	1500 x 1125	
OE1817-V	1800 x 1850	1700 x 1275	
OE2017-V	2000 x 1850	1900 x 1425	
OE2217-V	2200 x 1800	2100 x 1575	
OE2420-V	2400 x 2050	2300 x 1725	
OE2724-V	2700 x 2250	2600 x 1950	
OE3024-V	3000 x 2350	2900 x 2175	

Wide Format, 16 : 9

ART. NO	SCREEN SIZE WIDTH x HEIGHT	VIEW AREA WIDTH x HEIGHT	WT. KG
OE1617-W	1600 x 1850	1500 x 845	
OE1817-W	1800 x 1850	1700 x 955	
OE2017-W	2000 x 1850	1900 x 1070	
OE2217-W	2200 x 1800	2100 x 1180	
OE2417-W	2400 x 1800	2300 x 1295	
OE2724-W	2700 x 2050	2600 x 1460	
OE3024-W	3000 x 2050	2900 x 1630	

All weights are gross (total weight including packaging, brackets etc.).

Standard screen material is white. Screens with Greylight, Greyline, ReAct, Rear Projection and Acoustic fabric are available in sizes with maximum height of 2400 mm.

For article numbers with Greylight replace OE by OGE. Example: An 2217-W with Greylight fabric = OGE2217-W

For article numbers with Greyline replace OE by OGLE. Example: An 2217-W with Greyline fabric = OGLE2217-W

For article numbers with ReAct replace OE by OES. Example: An 2217-W with ReAct fabric = OES2217-W

For article numbers with Rear Projection replace OE by ORE. Example: An 200 with Rear Projection fabric = ORE200

For article numbers with Acoustic replace OE by OAE. Example: An 2217-W with Acoustic fabric = OAE2217-W

The first part of the article number indicates the control option; OE = Switch and OEI = Installation. Example: An 1817-V with ReAct fabric for Installation = OESI1817-V
Inline Switch is supplied with euro plug as standard. For UK plug add -UK at the end of the article number. Example: An 1817-V with ReAct fabric and UK plug = OES1817-V-UK

For article numbers with CinemaScope (2.35:1), please see our pricelist.

Accessories

ARTICLE NO	
210603	Switch, 2-positions
210660	RF-control, 3-positions, euro plug
210660-UK	RF-control, 3-positions, UK plug

ARTICLE NO	
210604	Keypress, 3-positions
400300	Screen Cleaning Spray, 250 ml

